

Delete all remote controls

Attention: this procedure does not delete upper, lower limits or the favorite positions 1 and 2.

1. Hold the **HEAD** button for 3 seconds, until the motor moves up and down, then release it.

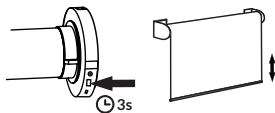

2. Hold the **HEAD** button for 7 seconds, until the motor moves up and down.

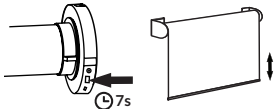

Troubleshooting

Motor is not responding

Insufficient battery - Please charge the battery at least for 2 hours and try again. Full battery charge may take about 6 hours.

Not holding the HEAD button long enough - To enter pairing mode, you need to press the button, and keep it pressed, for 3 seconds, until the motor moves up and down.

Cannot pair with remote control

The motor pairing mode lasts 30 seconds. Pressing the set button on the back of the remote control should be done within this period.

Make sure you are using the right remote control and it has a battery. In doubt, please check our website neosmartblinds.com. If the environment has too much 433MHz RF devices (RF noise), it may interfere to the pairing process.

Motor moves to the opposite direction

Simply reverse the direction. To know what is the key combination, please check your remote control instructions.

Motor only moves inch by inch in one or both directions

This behavior means that the upper and/or lower limits have not been set. Please refer to the setting limits section of this document (back of this page). If you are using a remote control, head to our website for instructions (neosmartblinds.com/motors-accessories/).

Warranty

Neo Lithium Battery Tubular Motor (TM-RB25-1.1/30) carries a three year warranty counting from the invoice date. Normal wear and tear are excluded from the warranty.

Disposal

This motor contains lithium battery. Do not dispose of in general waste. Please recycle batteries and damaged electric products according to local regulations.

Neo Lithium Battery Tubular Motor specifications

Description: 25 mm RF motor with 6.5" (16.5 cm) Neo Blue Link connection cable, 7.8" (20 cm) solar panel cable and 6.8" (17.5 cm) Micro-USB cable. Length of cables may vary.

Radio Frequency (RF): 433.92 MHz.

Electrical parameters: 8.4 V DC internal rechargeable lithium battery.

Power sources: 5 V/1 A Micro-USB charger or 2 W/11 V solar panel.

Operational parameters: 1.1 Nm, 30 rpm.

Compatible products to automate your home



Smart Controller

Control your blinds from anywhere using your phone or tablet. Voice commands are available when integrated with Amazon Alexa or Google Home (coming soon).

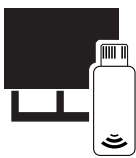

Blue Link

Local control of your motorized blinds using your phone or tablet. Set schedules to automate your home. No need to connect to your Wi-Fi or router.

For more information about our motors, remote controls and compatible products please visit our website. To buy one of these products, please contact your dealer.

neosmartblinds.com

In case of problem or doubt, please contact your dealer.

NEO LITHIUM BATTERY TUBULAR MOTOR

Works with all Neo Remote Controls RC-200
Version 4.0

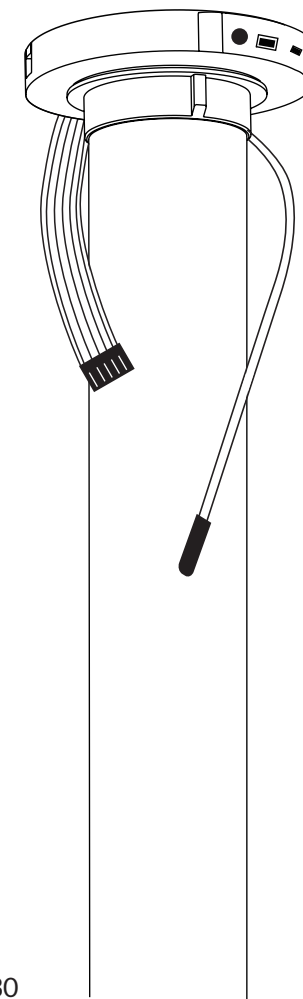

Models
TM-RB25-1.1/30

powered by Neo Smart Blinds

ENGLISH

Getting to know your Neo Lithium Battery Tubular Motor

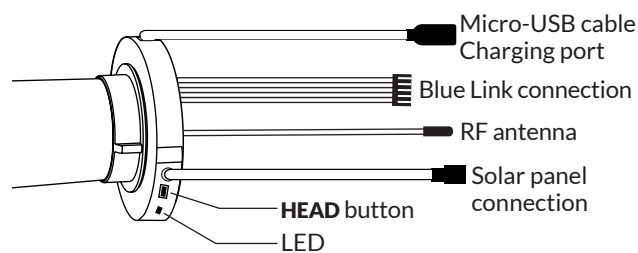

Motor dimensions

All dimensions are in millimeters. For cable, connections and antenna length, please see the motor specification section on the back.

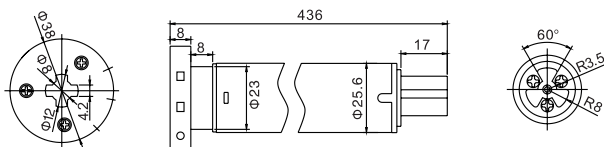

Charging options

The motor has an 8.4V DC rechargeable lithium battery and it can be charged using a 5V/1A micro-USB charger or a 2W/11V solar panel. Before first use, we recommend to fully charge the battery using a micro-USB charger.

Basic operation

Head Press	Function	Feedback	Description
Hold for 3 seconds	Pairing mode	Motor jogs LED on	Enters and stays in pairing mode for 30 seconds
Press once	Exit	LED off	If in pairing mode, it exits the mode
Hold for 3 seconds, release, then hold it for 7 seconds	Delete remote controls	Motor jogs LED on, then off	Enters pairing mode, then the motor deletes all remote control channels

Features

- Built-in lithium battery lasts up to 6 months
- Charge using standard micro-USB charger or Neo solar panel
- Quiet motor (38 dB)
- Easily set the upper and lower limits
- Two favorite positions
- Works with Neo Remote Controls RC200 series
- Can work with your phone by connecting the optional Blue Link to the motor
- Comes ready to work with the Neo Smart Controller to enable local and cloud control

Caution

- Motor must be installed in a horizontal position and used with tubular blinds.
- Ensure correct crown and drive adapters are used.
- Keep remote controls, Smart Controller device, Blue Link device and apps away from children.
- Ensure all cables and connected devices are protected and clear from moving parts.
- An environment with multiple 433MHz devices may interfere with the normal usage of the motor.
- Misuse or any design modification will void warranty.

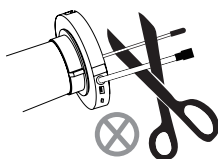

DO NOT CUT ANY CABLES OR THE ANTENNA

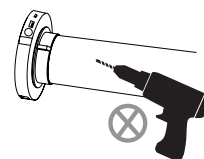

DO NOT DRILL OR CUT ANY PART OF THE MOTOR

Scan the QR Code to access the Remote Control instructions page available in our website.



Or type the address below neosmartblinds.com/motors-accessories/

Pairing process

Up to 16 channels can be stored on the motor.

Using a Neo Remote Control

All our Neo Remote Controls of RC200 series work with the motor.

1. Using the remote control, press the **CHANNEL** button as many times needed to select the desired channel to pair the motor. RC215, RC230 - Press the PREVIOUS CHANNEL or the NEXT CHANNEL buttons instead.



2. Hold the **HEAD** button for 3 seconds, until the motor quickly moves up and down.

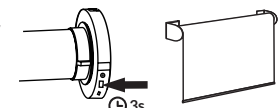

3. Press the **SET** button on the back of the remote control, the motor will move up and down to confirm the operation.

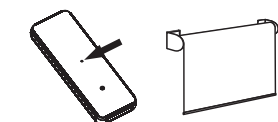

Using a Neo Smart Controller

Download the app to your phone or tablet by searching **Neo Smart Blinds** on Google Play or App Store.

1. Open the app and login. If you don't have an account, create one by tapping on **Create one**.

2. Follow the steps to add a Smart Controller.

If the step-by-step does not show up, tap on the **Menu** located on the top left corner, then tap on **Your Controllers**. Tap on the **plus button** to add your Smart Controller.

3. Tap on the **Menu** located on the top left corner, then tap on **Add a blind**. Follow the in-app instructions.

Setting limits

The motor comes with no limits set from the factory. In this case, up or down commands will be the same as step up and step down. Once the upper and lower limits are set, up and down will make the motor move to the respective limit and 2 favorite positions can be set.

To set the upper and lower limits, please refer to the remote control instructions available in our website. If you also own a Smart Controller or a Blue Link, you can use the respective app to set the limits.