

## Setting favorite positions

Once the open and close limits are set, the motor can store two favorite positions. After setting the favorite positions, **double press FAVORITE 1 or FAVORITE 2** button to send the motor to the favorite position 1 or 2. If you also use the Neo Smart Blinds Blue app to control your blinds, please read the related topic in the bottom of this page first.

### Setting favorite position 1

1. Use **OPEN** and **CLOSE** buttons to go to the desired favorite position 1.

2. **Double press** the **SET** button, then **double press** the **OPEN** button. This entire sequence must be completed within 10 seconds.

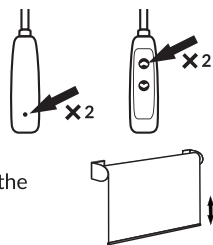

3. The motor will move to confirm that the favorite position 1 was saved.

### Setting favorite position 2

1. Use **OPEN** and **CLOSE** buttons to go to the desired favorite position 2.

2. **Double press** the **SET** button, then **double press** the **CLOSE** button. This entire sequence must be completed within 10 seconds.

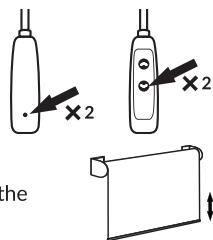

3. The motor will move to confirm that the favorite position 2 was saved.

## Deleting a favorite position

Delete a favorite position by setting it at the same position. Go to the desired favorite position to delete. Then, set the same favorite position, using the instructions above. The motor will move to confirm the favorite position was deleted.

## Neo Smart Blinds Blue app

**TM-WB25 with Blue Link:** None of the favorite positions set via wand are accessible to the Blue Link and the Neo Smart Blinds Blue app, however you can easily set up a favorite position in the app.



### Blue Link

Local control of your motorized blinds using your phone or tablet. Set schedules to automate your home. No need to connect to your Wi-fi or router.

## Troubleshooting

### Motor is not responding

**Insufficient battery:** Please charge the battery at least for 2 hours and try again. Full battery charge may take about 6 hours.

**Not holding the HEAD or SET button long enough:** To enter the programming mode, you need to press the button, and keep it pressed, for 5 seconds, until the motor moves.

### Motor only moves inch by inch in one or both directions

This behavior means that the open and/or close limits have not been set. Please refer to the setting limits section.

### The motor is not responding when a button on the wand is double pressed

This behavior indicates that there is too much time between presses, causing the motor to interpret them as two separate presses. A double press is performed by quickly pressing the button twice, with less than half a second between presses.

## Motor specifications

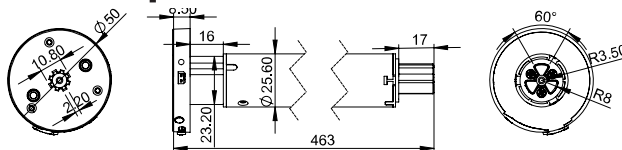

All dimensions are in millimeters

**Description:** 25 mm motor, solar panel connection and Blue Link connection.

**TM-WB25-1.1/30:** micro-USB wand/charging port.

**TM-WB25-CN-1.1/30:** USB-C wand/charging port.

**Electrical parameters:** 8.4 V DC internal rechargeable lithium battery.

**Power sources:** 5 V/1 A charger or 2 W/15 V solar panel.

**Operational parameters:** 1.1 Nm, 30 rpm.

For more **information and instructions on our motors and other products**, visit our website at [neosmartblinds.com](https://neosmartblinds.com) or our Help Center at [help.neosmartblinds.com/portal/](https://help.neosmartblinds.com/portal/).

### Disposal

The Neo Battery Tubular Motors contain an internal lithium battery. Do not dispose of these items with your regular waste. Please recycle batteries and damaged electronic products according to local regulations.

# NEO SMART BLINDS NEO WAND MOTOR

Version 5.3

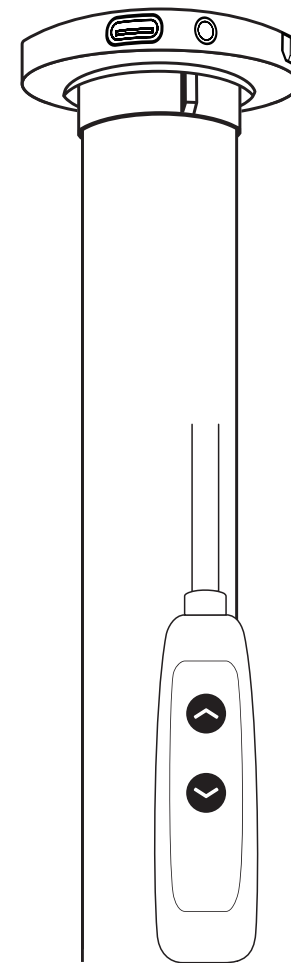

ENGLISH

### Models

TM-WB25-1.1/30

TM-WB25-CN-1.1/30

## Getting to know the Neo Wand Motor

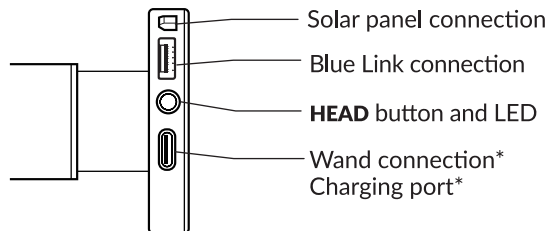

\*TM-WB25-1.1/30: micro-USB

\*TM-WB25-CN-1.1/30: USB-C

## Getting to know the wand

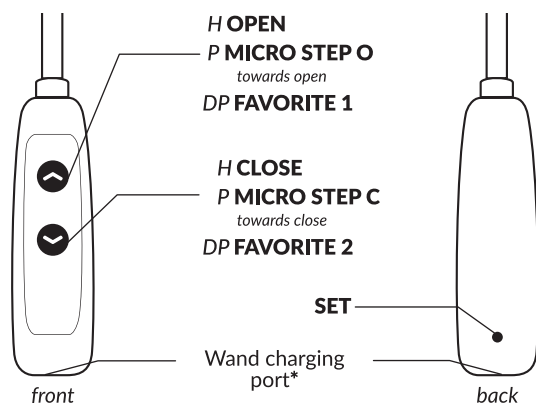

P - Press the button once  
DP - Double press the button  
H - Hold the button for 1 second

### Caution

- Motor must be installed in a horizontal position and used with correct crown and drive adapters for tubular blinds.
- Keep wand, Blue Link and its app away from children.
- Ensure all cables and connected devices are protected and clear from moving parts.
- Misuse or any design modification will void warranty.

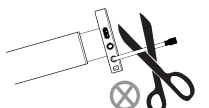

DO NOT CUT ANY CABLES



DO NOT DRILL OR CUT ANY PART OF THE MOTOR

## Basic operation

Key	Description
Hold <b>OPEN</b> for 1 second	The motor moves all the way to the open limit <sup>1</sup> .
Hold <b>CLOSE</b> for 1 second	The motor moves all the way to the close limit <sup>1</sup> .
Press <b>OPEN</b> or <b>CLOSE</b>	The motor stops any ongoing motion.
Press <b>MICRO STEP O</b>	The motor moves a small amount towards the open limit.
Press <b>MICRO STEP C</b>	The motor moves a small amount towards the close limit.
Double press <b>FAVORITE 1</b>	The motor moves to the favorite position 1 <sup>2</sup> .
Double press <b>FAVORITE 2</b>	The motor moves to the favorite position 2 <sup>2</sup> .

1 - The motor will stop on button release if the limit is not yet set.

2 - The motor will take no action if the favourite position is not yet set.

## Charging the motor's battery

Plug in the charging cable in the wand charging port, located at the bottom of the wand, or the motor's charging port. The motor's LED on the head will turn on to indicate the battery is charging. Once the battery is fully charged, the LED will turn off.



### Solar panel installation *optional*

The solar panel must be within reach of the solar panel port located on the motor head when selecting a mounting location. Attach the 2 provided mounts to the window frame, positioning them 10 in (25 cm) apart from each other. Once the mounts are securely attached to the frame, install the solar panel blue side facing outward, and connect the provided cable to the solar panel port.

## Reverse direction

1. Hold the **SET** button on the back of wand for 5 seconds. The motor will move to indicate the process has started.

2. Then, hold the **SET** button on the back of wand for 5 seconds again. The motor will move to indicate that its direction was reversed.

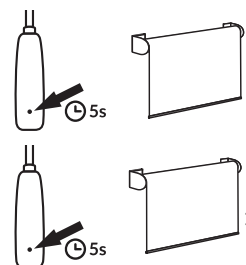

## Setting or adjusting limits

The motor's open and close limits are set individually.

### Open limit

1. Hold the **SET** button for 5 seconds. The motor will move to indicate the process to set the limit has started.

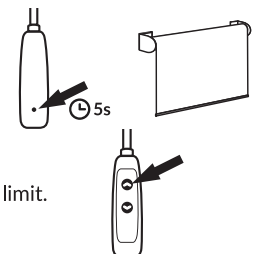

2. Press **OPEN** to adjust the open limit.

3. Use **OPEN** and **CLOSE** buttons to go to the desired open position.

4. Press **SET** button on the back of the wand. The motor will move to confirm that the new open limit position has been saved.

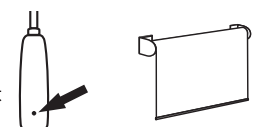

### Close limit

1. Hold the **SET** button for 5 seconds. The motor will move to indicate the process to set limit has started.

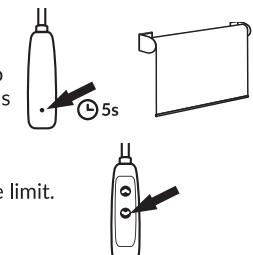

2. Press **CLOSE** to adjust the close limit.

3. Use **OPEN** and **CLOSE** buttons to go to the desired close position.

4. Press **SET** button on the back of the wand. The motor will move to confirm that the new close limit position has been saved.

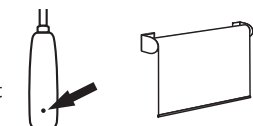

## Delete limits and favorite positions

**Attention:** A motor without open and close limits will only move a small amount when **OPEN** or **CLOSE** is pressed or holded.

1. Double press the **SET** button on the back of the wand. The LED on the motor's head will turn on to indicate the process has started.



2. Hold the **SET** button for 5 seconds. The motor will move to indicate the process has finished.

