

## Close limit

1. Hold the **SET + CLOSE** buttons at the same time for 3 seconds. The motor will move to indicate the process has started.



2. Use **OPEN** and **CLOSE** buttons to go to the desired closed position.



3. Press **SET** button on the back of the remote control. The motor will move to indicate that the close limit has been saved.

## Setting favorite positions

### Favorite position 1

1. Use **OPEN**, **STOP** and **CLOSE** buttons to go to the desired favorite position 1.

2. Press the **SET + FAVORITE 1** buttons at the same time. The motor will move to confirm that the favorite position 1 was saved.



### Favorite position 2

1. Use **OPEN**, **STOP** and **CLOSE** buttons to go to the desired favorite position 2.

2. Press the **SET + FAVORITE 2** buttons at the same time. The motor will move to confirm that the favorite position 2 was saved.



## Setting speed

1. Hold the **SET** button for 3 seconds. The motor will move to indicate the process has started.

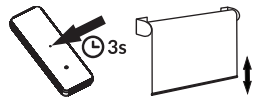

2. Hold the **CLOSE**, **STOP** or **OPEN** button for 3 seconds to set the speed to low, medium or high. The motor will move to indicate the speed setting has been saved.

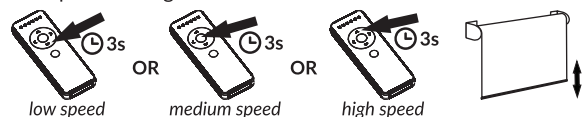

## Reverse direction

1. Hold the **SET** button on the back of the remote control for 3 seconds. The motor will move up and down to indicate the process has started.

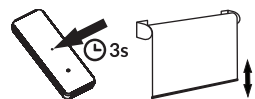

2. Press the **CHANNEL\* + STOP** buttons at the same time, the motor will move up and down to confirm the operation.



\*RC215, RC230: Press the **PREVIOUS CHANNEL + STOP** buttons at the same time.

## Delete limits

1. Hold the **SET + STOP** buttons at the same for 3 seconds. The motor will move to indicate the limits have been deleted.



## Delete all remote controls

**Note:** this procedure does not delete open and close limits or the favorite positions 1 and 2.

1. Hold the **HEAD** button for 3 seconds, until the motor moves, then release it.

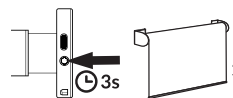

2. Hold the **HEAD** button for 7 seconds, until the motor moves.

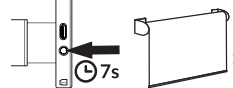

## Troubleshooting

### Motor is not responding

**Insufficient battery:** Please charge the battery at least for 2 hours and try again. Full battery charge may take about 6 hours.

**Not holding the HEAD button long enough:** To enter pairing mode, you need to press the button, and keep it pressed, for 3 seconds, until the motor moves.

### Cannot pair with remote control

The motor pairing mode lasts 30 seconds. Pressing the set button on the back of the remote control should be done within this period. Make sure you are using the right remote control and it has a battery. If there are too many 433MHz RF devices transmitting in the environment (RF noise), it may interfere with the pairing process.

### Motor only moves inch by inch in one or both directions

This behavior means that the open and/or close limits have not been set. Refer to the setting limits section. For other remote control models, please consult [help.neosmartblinds.com/portal/](http://help.neosmartblinds.com/portal/).

For further information, please consult [help.neosmartblinds.com/portal/](http://help.neosmartblinds.com/portal/).

## Motor specifications

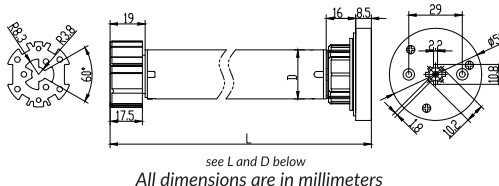

### TM-RB25-C-2/22-26 supports external Blue Link

**Description:** 26.6 mm diameter (D), 563mm in length (L), RF 433.92 MHz, external antenna, 2 Nm, 3 adjustable speeds between 22 to 26 rpm, solar panel connection, 12.6 V DC internal rechargeable lithium battery, 5 V/1 A charger or 2 W/15 V solar panel.

### Disposal

The Neo Battery Tubular Motors contain an internal lithium battery. Do not dispose of these items with your regular waste. Please recycle batteries and damaged electronic products according to local regulations.

# NEO SMART BLINDS NEO BATTERY TUBULAR MOTOR

Version 7.1.1

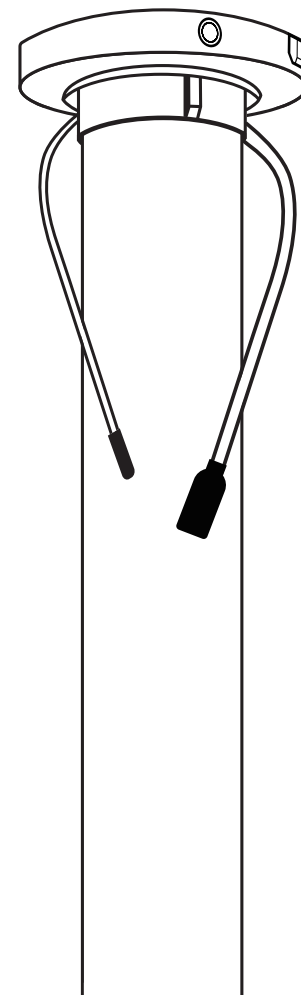

ENGLISH

## Models

TM-RB25-C-2/22-26 USB-C extension

## Getting to know your Neo Battery Tubular Motor

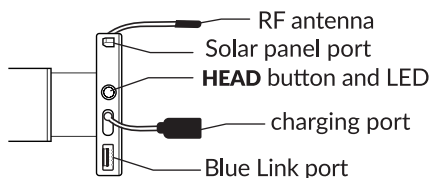

### Battery charging options

The motor comes with an internal rechargeable battery that can be charged using a 5V/1A charger or a compatible solar panel. It is recommended to fully charge the battery before the first use, and this may take up to 6 hours. When the battery is empty, the motor will not move, and pressing the **HEAD** button will turn the LED on for 25 seconds. All supported motors, when used with the correct accessories, can provide the battery level information through the Neo Smart Blinds and the Neo Smart Blinds Blue apps at all times.

### Solar panel installation *optional*

The solar panel must be within reach of the solar panel port located on the motor head when selecting a mounting location. Attach the 2 provided mounts to the window frame, positioning them 10 in (25 cm) apart from each other. Once the mounts are securely attached to the frame, install the solar panel blue side facing outward, and connect the provided cable to the solar panel port.

### Caution

- Motor must be installed in a horizontal position and used with correct crown and drive adapters for tubular blinds.
- Keep remote controls, Smart Controller, Blue Link and apps away from children.
- Ensure all cables and connected devices are protected and clear from moving parts.
- An environment with multiple 433MHz devices may interfere with the normal usage of the motor.
- Misuse or any design modification will void warranty.



Scan the QR code to access the Remote Control instructions page on our website, or visit:  
<https://help.neosmartblinds.com/portal/>



## Neo Remote Control *Models RC201, RC202, RC206*

For other remote control models, please refer to the instructions inside the box of the remote control.

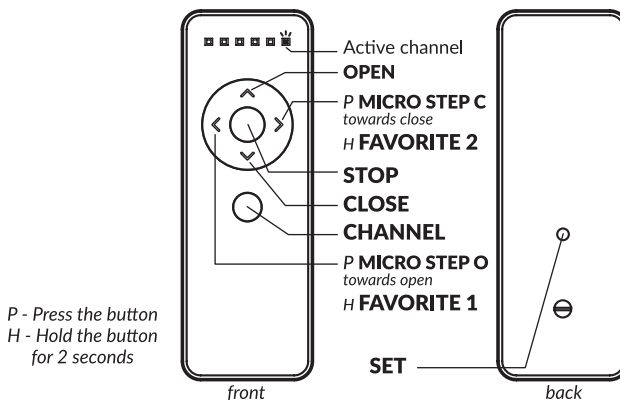

*For a remote control to execute commands on a motor, its active channel must be paired with that motor. Refer to the "Pairing Process" section for instructions.*

### Basic operation

Key	Description
Hold <b>HEAD</b> for 3 seconds	The motor enters and stays in pairing mode for 30 seconds
Press <b>HEAD</b> once	If the motor is in pairing mode, it exits the mode
Hold <b>HEAD</b> for 3 seconds, release it, then hold it for 7 seconds	The motor enters pairing mode; then, it deletes all remote control channels registered in memory.
Press <b>OPEN</b>	The motor moves all the way to the open limit.
Press <b>CLOSE</b>	The motor moves all the way to the close limit.
Press <b>STOP</b>	The motor stops any ongoing motion.
Press <b>MICRO STEP O</b>	The motor moves a small amount towards the open limit.
Press <b>MICRO STEP C</b>	The motor moves a small amount towards the close limit.
Hold <b>FAVORITE 1</b> for 2 seconds	The motor moves to the favorite position 1.
Hold <b>FAVORITE 2</b> for 2 seconds	The motor moves to the favorite position 2.
Press <b>CHANNEL</b>	The remote control cycles to the next channel (or group of channels), making it active <sup>1</sup> .

1 - This command is not sent to the motor, and affects only the remote control on which it is executed.

## Pairing process

Up to 16 channels can be stored on the motor.

### Using a Neo Remote Control

**1. Using the remote control**, press the **CHANNEL** button as many times needed to **select the desired channel** to pair the motor.

RC215, RC230: Press the **PREVIOUS CHANNEL** or the **NEXT CHANNEL** buttons.

**2.** Hold the **HEAD** button for 3 seconds, until the motor moves.

**3.** Press the **SET** button on the back of the remote control, the motor will move to confirm the operation.

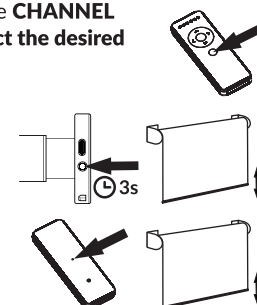

### Using the mobile apps

#### Neo Smart Blinds

Download the app to your mobile device by searching **Neo Smart Blinds** on Google Play or App Store. You will need to create an account and **add a Smart Controller before pairing blinds** to the app.

**TM-RB25:** Compatible with all Smart Controller models.

**TM-RB25 with Blue Link, TM-BRB25:** Compatible with all Smart Controller models, but only C-BR300 model will be able to show battery level and the blind's current position.

#### Neo Smart Blinds Blue

Download the app to your mobile device by searching **Neo Smart Blinds Blue** on Google Play or App Store. Currently it supports **TM-RB25 with Blue Link** and **TM-BRB25** motors.

## Setting limits

If the motor comes with no limits set from the factory, the open and close commands will be the same as micro step o and micro step c.

### Open limit

**1.** Hold the **SET + OPEN** buttons at the same time for 3 seconds. The motor will move to indicate the process has started.

**2.** Use **OPEN** and **CLOSE** buttons to go to the desired opened position.

**3.** Press **SET** button on the back of the remote control. The motor will move to confirm that the open limit has been saved.

